

REVISIONS				
ZONE	REV	DESCRIPTION	DATE	APPROVED

FRONT VIEW

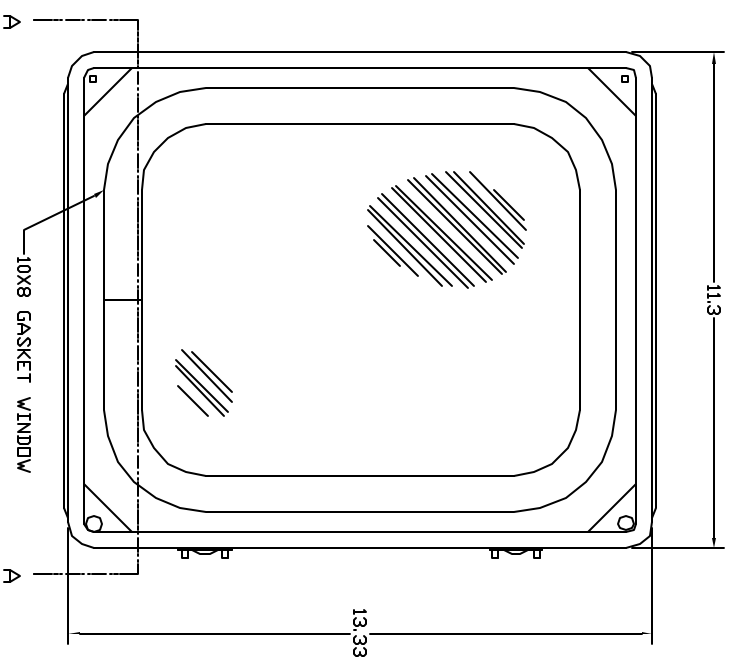

RIGHT SIDE VIEW

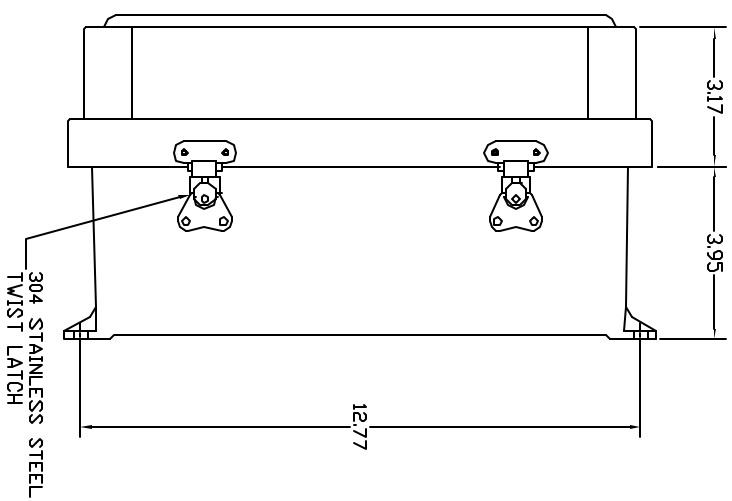

FRONT VIEW-COVER REMOVED

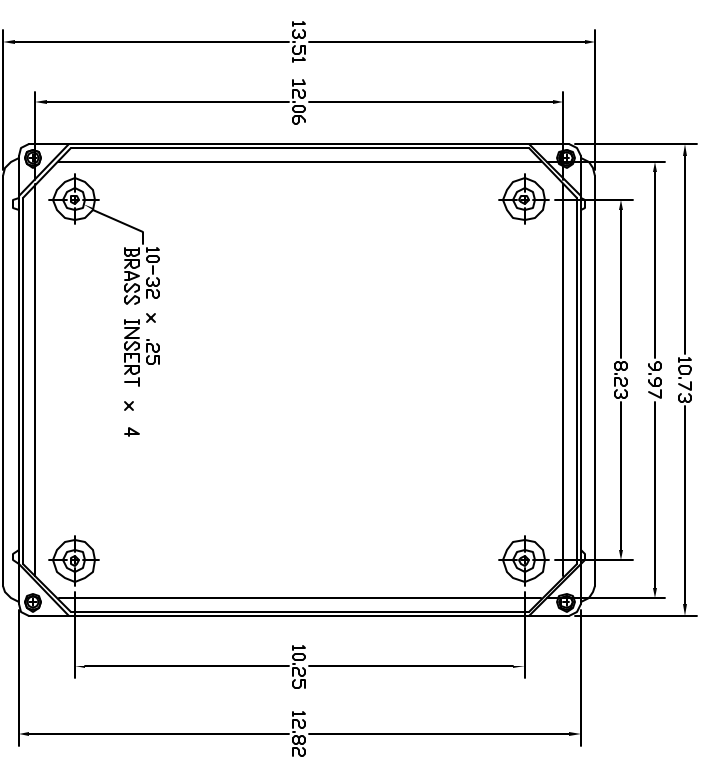

END VIEW

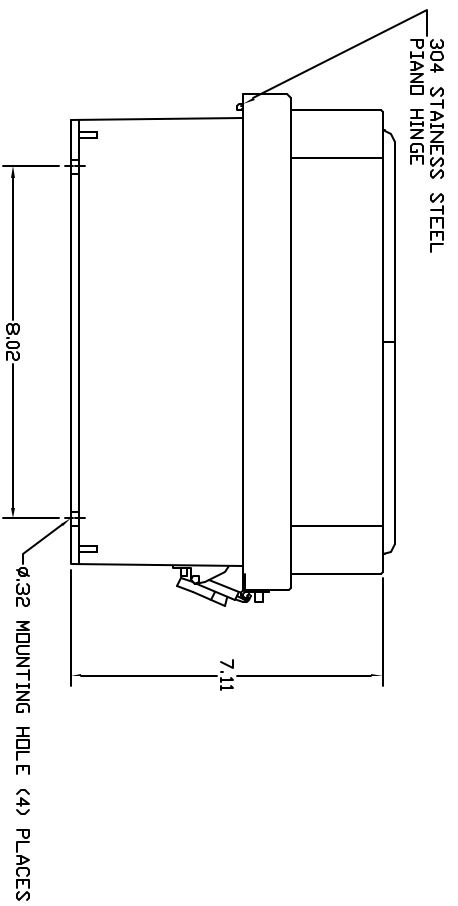

SECTION A-A

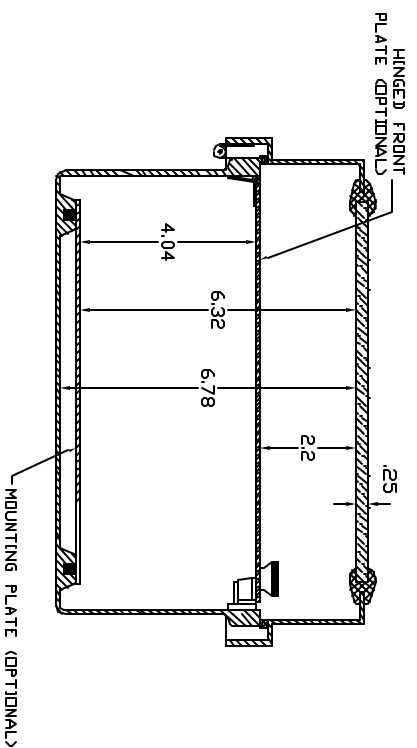

- NOTES:
1. ENCLOSURE MATERIAL MADE OF GRAY (RAL 7036) HOT MOLDED FIBERGLASS REINFORCED POLYESTER.
 2. UL LISTED PER STD. 508. (FILE# E54315)
 3. CSA CERTIFIED PER STD. C22.2 NO. 94. (FILE# LR36508)
 4. NEMA RATED TYPE 3, 3R, 3S, 4, 4X, 12 AND 13.
 5. IEC 529 RATED IP 68.
 6. TEMPERATURE RANGES FROM -50 DEG C TO 150 DEG C.
 7. SELF EXTINGUISHING AND HALOGEN FREE.
 8. ACCESSORIES INCLUDE: BACK PANELS, DEAD FRONT PANELS, HINGED FRONT PLATES, HINGED COVERS, PRINT POCKETS, LATCHES, WINDOWS, AND VENTILATORS.
 9. CABINETS ARE MAINTENANCE FREE AND CORROSION RESISTANT.

UNLESS OTHERWISE SPECIFIED, DIMENSIONS ARE IN INCHES			
DECIMALS .XX ± .02 .XXX ± .010 DO NOT SCALE DRAWING		RVL SERIES ENCLOSURE WYNCKLER PART# RVLG1210HWLL2	
DRAWN	DATE	DWG NO.	REV
KEITH CHAPMAN	02/21/01	RVLG1210HWLL2	0
CHECKED	DESIGN	SCALE	SHEET
		FULL	0

THIS DRAWING IS THE CONFIDENTIAL AND PROPRIETARY PROPERTY OF WYNCKLER ENCLOSURE SYSTEMS, AND SHALL NOT BE REPRODUCED OR DISCLOSED TO OTHERS EXCEPT BY EXPRESS WRITTEN PERMISSION OF WYNCKLER ENCLOSURE SYSTEMS INC.